

*** ATTENTION: GORBEL INC. ASSUMES NO RESPONSIBILITY FOR ADEQUACY OR INTEGRITY OF THE MOUNTING SURFACES OR THE STRUCTURE THAT THE CRANE MAY BE MOUNTED TO. GORBEL INC. WILL NOT BE LIABLE FOR ANY LOSS, INJURY OR DAMAGE TO PERSONS OR PROPERTY, NOR FOR DAMAGES OF ANY KIND, RESULTING FROM THE FAILURE OR DEFECTIVE OPERATION OF ANY MATERIALS NOT SUPPLIED DIRECTLY BY GORBEL INC. BRACING SYSTEMS, IF USED, MUST BE APPROVED BY A LOCAL PROFESSIONAL ENGINEER. BRACING IS NOT REQUIRED BUT IS RECOMMENDED. GROUTING UNDER THE BASEPLATE IS HIGHLY RECOMMENDED.

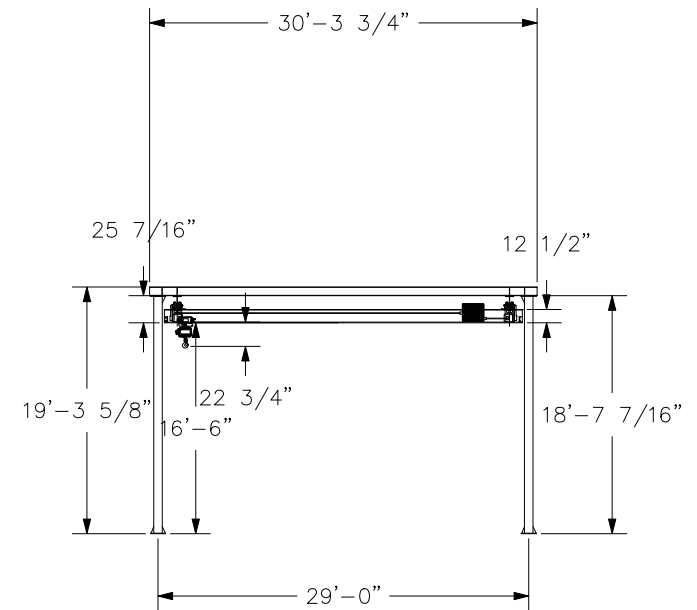
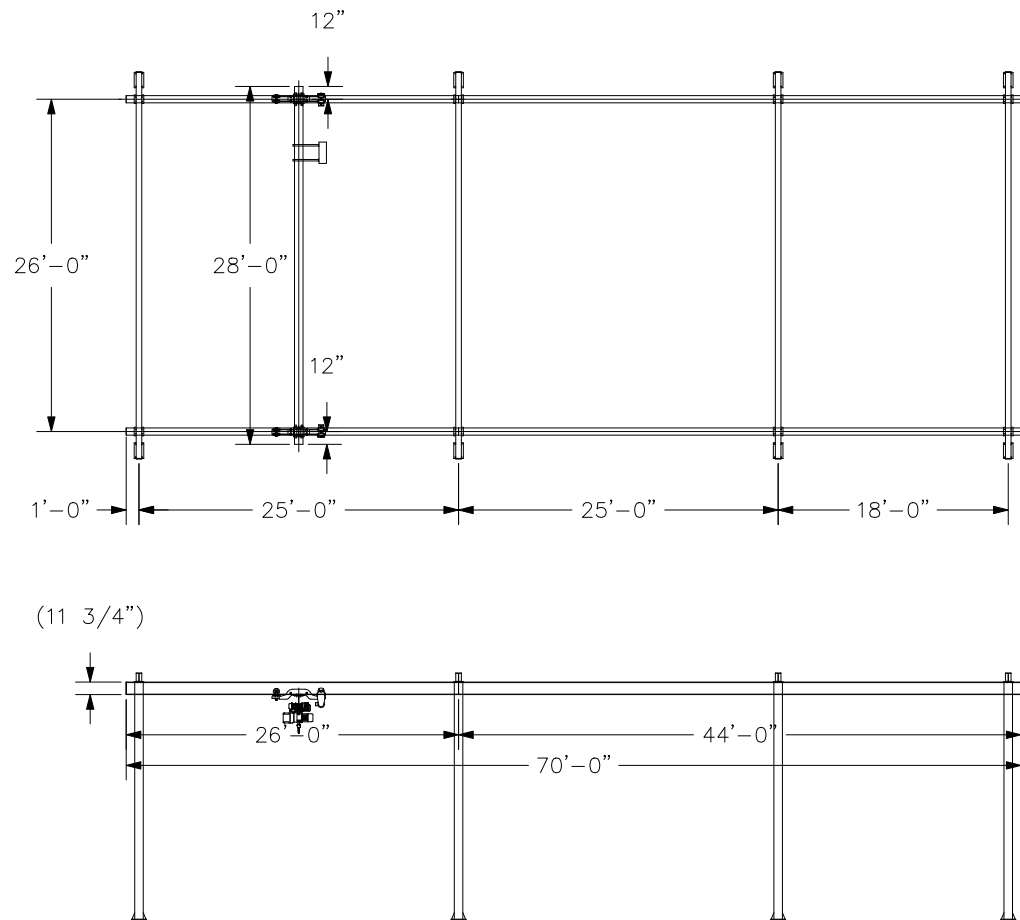

LATERAL COLUMN LOAD: 1.040 KIPS
LONGITUDINAL COLUMN LOAD: 0.596 KIPS

HANGERS MUST BE LOCATED AT A SPLICE JOINT

DO NOT SCALE FROM DRAWING.
DIMENSIONS ARE STEEL TO STEEL AND MAY VARY.

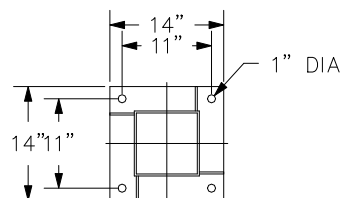

BASE PLATE MOUNTING DETAIL
4,880 LB ANCHOR BOLT LOAD MAX

MATERIAL HNDLG INNOVATIONS

CRANE INFORMATION		CLEVELAND TRAMRAIL By Gorbel Inc. 600 FISHERS RUN P.O. BOX 593 FISHERS, NY 14453-0593	
CAPACITY: 2.00 TONS			
BRIDGE OAL: 28'-0"			
BRIDGE RAIL: 5100		CT-FSU-25-H2-28-70-16.5	
RUNWAY OAL: 70'-0"		GENERAL ARRANGEMENT	
RUNWAY RAIL: 4600			
TOLERANCE: ±1/8		BY: jjlmhi	DATE: AUG 25, 2015
QUANTITY: 1		LINE: 3	
ID #: APC_ANKENY.3A.3A			